

# BXC\_EC

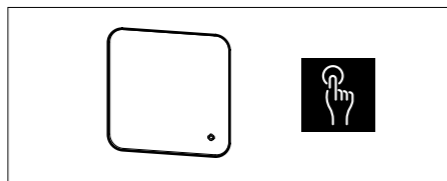

## Nyomás mérés

## Légáramlás beállítása

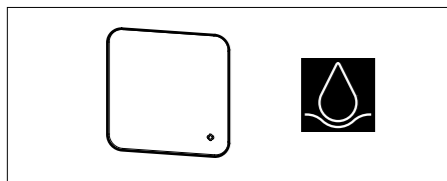
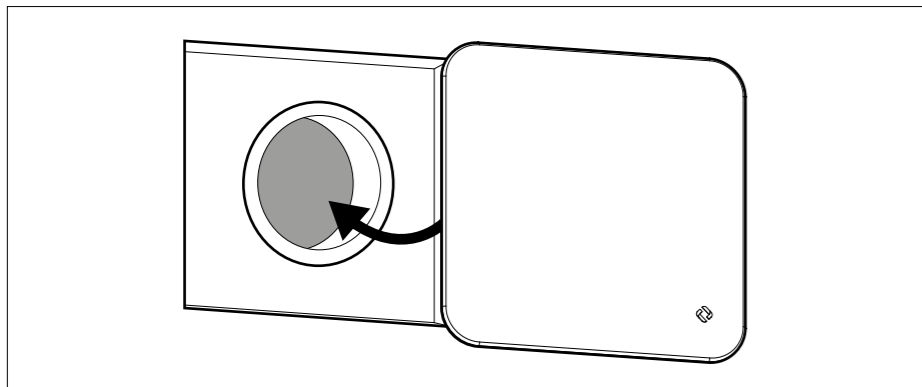

Aereco Légtechnika Kft.  
 1139 Budapest, Fáy u. 12/a. - Tel:  
 + 36 1 214 44 21 - fax (+36 1)  
 225 03 73 - e-mail:  
 aereco@aereco.hu -  
 www.aereco.hu

D7496\_A\_NOT\_POS\_BXE\_C\_HU

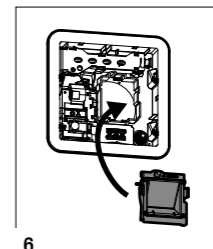
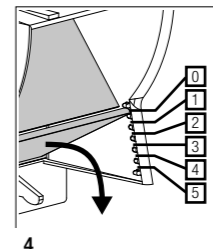
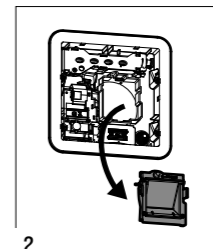
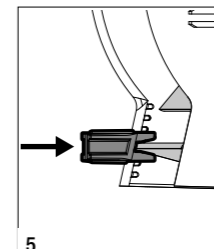
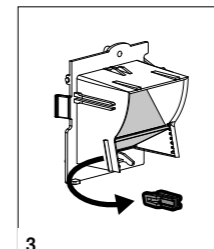
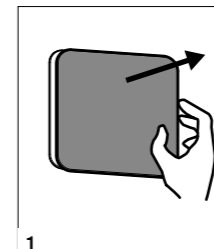
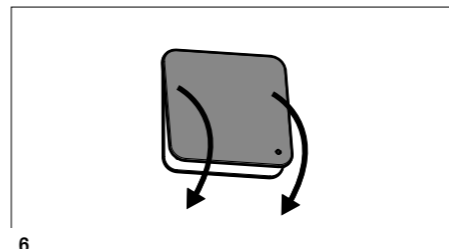
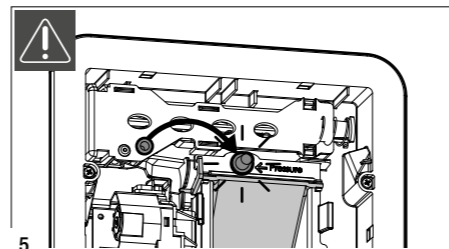
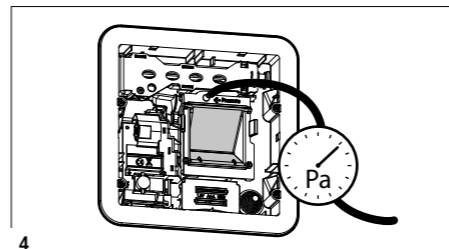
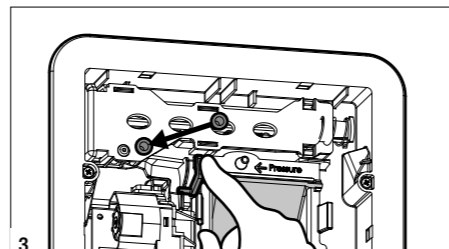
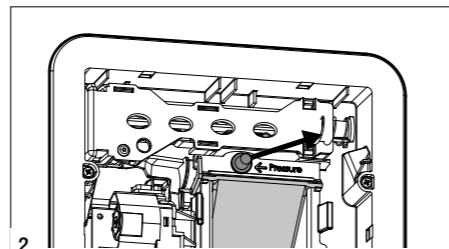
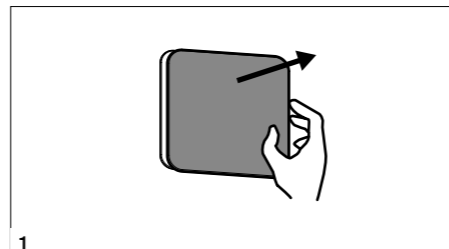

Ø 100 mm		
Pozíció	Min Légáramlás (m³/h) @ 100 Pa	Max Légáramlás (m³/h) @ 100 Pa
0	12	80
1	18	90
2	24	100
3	30	110
4	36	120
5	42	130

Ø 125 mm		
Pozíció	Min Légáramlás (m³/h) @ 100 Pa	Max Légáramlás (m³/h) @ 100 Pa
0	12	70
1	18	80
2	24	90
3	30	100
4	36	110
5	42	120

Ø 100 mm		
Pozíció	Min Légáramlás (m³/h) @ 100 Pa	Max Légáramlás (m³/h) @ 100 Pa
0	12	70
1	18	76
2	24	82
3	30	88
4	36	94
5	42	100

# BXC\_EC

