



# MVHBA



## Bifurcated cased axial fans with motors outside the air flow



Bifurcated cased fans for transferring air up to 150°C in continuous operation and up to 200°C in sporadic mode.

**Fan:**

- Cased sheet steel casing
- Cast aluminium impeller
- Impeller to motor airflow direction

**Motor:**

- IE3 efficiency motors for powers equal to or higher than 0.75 kW except single-phase, 2-speed and 8-pole
- Class F motors with ball bearings and IP55 protection
- Three-phase 230/400 V-50 Hz (up to 4 kW) and 400/690 V-50 Hz (powers higher than 4 kW)

- Operating temperature: -25°C +150°C

**Finish:**

- Anti-corrosive finish of polyester resin polymerised at 190°C, previously degreased with phosphate-free nanotechnological treatment

**On request:**

- Stainless steel casing
- Hot dip galvanised finish
- Special windings for different voltages and motors with PTC

### Order code

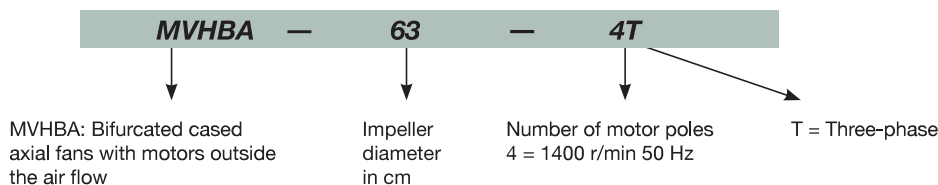

### Technical characteristics

Model	Speed (r/min)	Max. admissible current (A)		Installed power (kW)	Maximum flow rate (m³/h)	Sound pressure level dB(A)	Approx. weight (kg)
		230 V	400 V				
MVHBA-31-2T	2760	2.57	1.49	0.55	2900	77	25
MVHBA-31-2M	2810	3.49		0.55	2900	77	26
MVHBA-31-4T	1350	1.66	0.96	0.25	1600	66	24
MVHBA-31-4M	1370	2.00		0.25	1600	66	25
MVHBA-40-2T IE3	2830	4.03	2.34	1.10	6200	82	46
MVHBA-40-2M	2820	6.51		1.10	6200	82	46
MVHBA-40-4T	1370	2.02	1.17	0.37	3200	75	40
MVHBA-45-2T IE3	2910	10.00	5.77	3.00	8550	84	61
MVHBA-50-4T IE3	1420	2.82	1.62	0.75	6750	76	74
MVHBA-63-4T IE3	1455	4.07	2.34	1.10	11150	77	95
MVHBA-71-4T IE3	1450	13.90	8.00	4.00	15850	79	166
MVHBA-71-6T	900	2.99	1.73	0.55	11200	74	140
MVHBA-80-6T IE3	945	4.68	2.69	1.10	14900	77	196
MVHBA-100-6T IE3	945	4.68	2.69	1.10	21700	80	266

### Accessories

See accessories section.

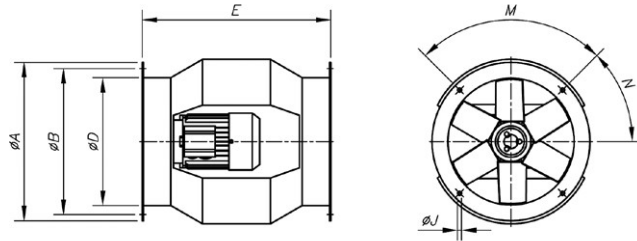
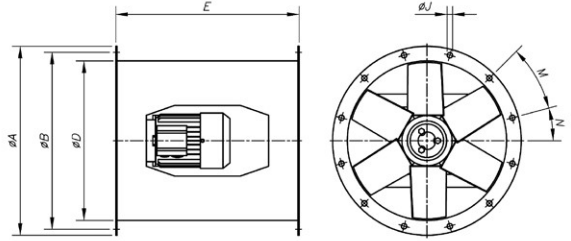

## Dimensions mm

**MVHBA-31...50**

**MVHBA-63...100**

Model	ØA	ØB	ØD	E	ØJ	M	N
MVHBA-31	385	355	308	460	10	4x90°	45°
MVHBA-40	490	450	410	580	12	8x45°	22,5°
MVHBA-45	540	500	460	640	12	8x45°	22,5°
MVHBA-50	600	560	514	730	12	12x30°	15°
MVHBA-63	730	690	640	730	12	12x30°	15°
MVHBA-71	810	770	710	770	12	16x22,5°	11,25°
MVHBA-80	900	860	800	830	12	16x22,5°	11,25°
MVHBA-100	1115	1070	1000	1270	15	16x22,5°	11,25°

## Characteristic curves

Q = Flow rate in m<sup>3</sup>/h, m<sup>3</sup>/s and cfm.

Pe = Static pressure in mm H<sub>2</sub>O, Pa and inwg.

### MVHBA

