

BP/M INOX

Stainless steel centrifugal fans especially designed for extracting hot air at a max. temperature of 80°C and water vapour from extract hoods with a vertical air outlet and made of Stainless steel
Especially designed for bread and pastry ovens as well as industrial ovens



Fan:

- Stainless sheet steel casing
- Stainless sheet steel multiblade impeller
- Motor directly coupled to flange B-5

- Maximum temperature of air to be carried: -25°C +80°C

Finish:

- Stainless sheet steel

Motor:

- IE3 efficiency motors for powers equal to or higher than 0.75 kW except single-phase, 2-speed and 8-pole
- IP55 protection
- Three-phase 230/400 V 50 Hz (up to 4 kW) and 400/690 V 50 Hz (powers higher than 4 kW)

On request:

- Special windings for different voltages
- Painted steel fan

Characteristics

MOD.	FRAME	kW	RPM	dB(A)	CAPACITY (m³/s)											
					0.008	0.017	0.03	0.06	0.07	0.08	0.1	0.12	0.13	0.16	0.17	
BP 100 M	63A2	0.18	2680	58				30	32	33	34	35	36	36	30	24
BP 100 M	63A4	0.18	1340	48	6	6	7	7	8	7						

Flow level margin ±5%
 Noise level margin +3...5 dB

Dimensions mm

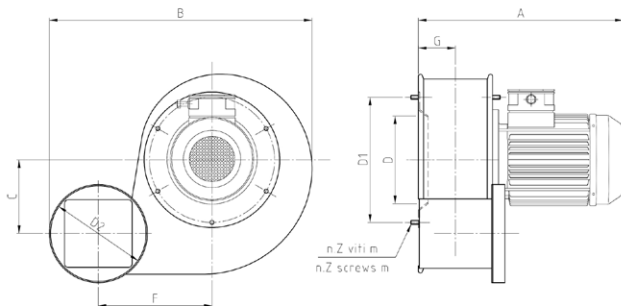

MOD.	FRAME	kW	RPM	A	B	C	F	G
BP 100 M	63A2	0.18	2680	255	330	96	142	48
BP 100 M	63A4	0.18	1340	255	330	96	142	48

MOD.	D	D1	m	Z	D2	kg
BP 100 M	110	160	M5	6	120	6.75
BP 100 M	110	160	M5	6	120	6.75

Characteristic curves

BP/M 100

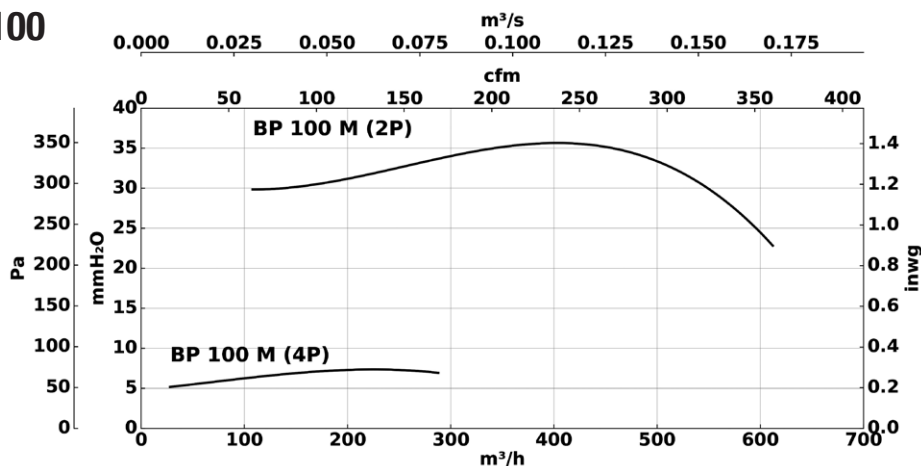

Total pressure
 Flow level margin ±5%
 Noise level margin +3...5 dB
 Margin of kW absorbed ±3%