

EARU

Centrifugal fans for extracting air from extract hoods and for industrial applications
Especially designed for extracting air in industrial applications



- Fan:**
- Sheet steel casing
 - Galvanised sheet steel multiblade impeller
 - Motor mounted on a B-3 System 4 support bench

- Motor:**
- IE3 efficiency motors for powers equal to or higher than 0.75 kW except single-phase, 2-speed and 8-pole
 - IP55 protection
 - Three-phase 230/400 V 50 Hz (up to 4 kW) and 400/690 V 50 Hz (powers higher than 4 kW)
 - Maximum temperature of air to be carried: -25°C +90°C

- Finish:**
- Corrosion resistant with heat resistant paint, aluminium in colour

- On request:**
- Special windings for different voltages
 - Stainless sheet fan casing

Characteristics

MOD.	FRAME	kW	RPM	dB	CAPACITY (m ³ /s)												
					0.37	0.42	0.47	0.53	0.6	0.67	0.75	0.83	0.92	1	1.17	1.33	
					TOTAL PRESSURE (mmH ₂ O)												
EARU 340	90S-2	1.5	2840	77	180	178	172	165	160	145	130	112	100	85			
EARU 370	90L-2	2.2	2850	79			218	215	210	200	190	175	162	150	120	100	

Flow level margin ±5%
 Noise level margin +3...5 dB

Dimensions mm

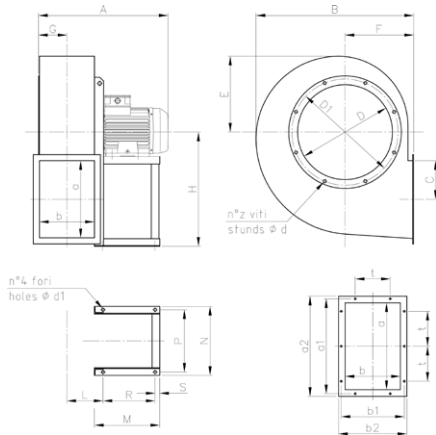

MOD.	FRAME	FAN						POS. TO FACE		
		A	B	C	E	F	G	0°	90°	270°
EARU 340	90S-2	450	585	250	280	270	96	425	425	425
EARU 370	90L-2	500	620	250	295	290	106	450	450	450

MOD.	BASE						INLET NOZZLE				
	L	M	N	P	R	S	d1	D*	D1	d	z
EARU 340	117	215	269	240	140	43	10	224	265	M8	8
EARU 370	127	215	269	240	140	43	12	250	292	M8	8

MOD.	OUTLET WEIGHT	
	a x b	kg
EARU 340	250 x 160	48
EARU 370	280 x 180	56

MOD.	a x b	a1	b1	a2	b2	t	z	d
EARU 340	250 x 160	292	202	324	235	112	6 + 4	11.5
EARU 370	280 x 180	332	232	364	265	125	6 + 4	11.5

Characteristic curves

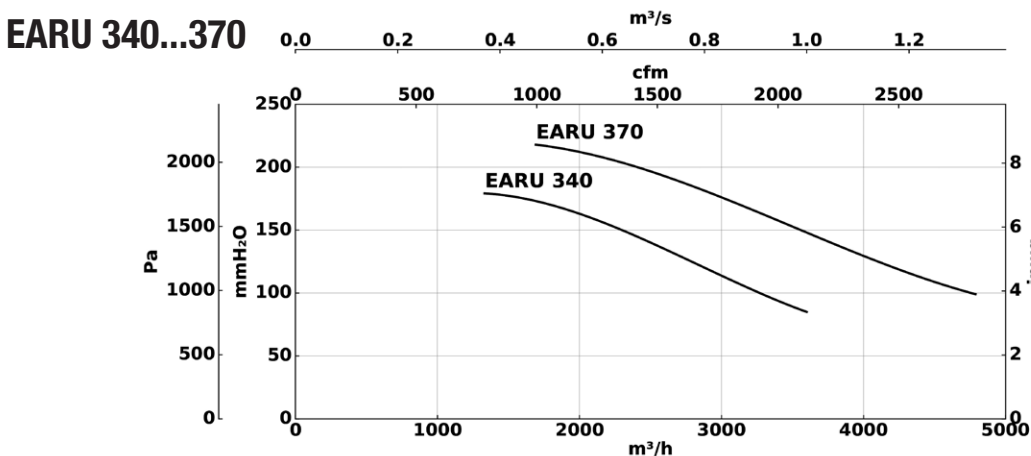

Total pressure
 Flow level margin ±5%
 Noise level margin +3...5 dB
 Margin of kW absorbed ±3%